

FEEL THE HEAT!

Stinger Front Bumper for Polaris General
 Part # **02-1101** General 1000 2016+ (All Models) Black

Congratulations on the purchase of the Stinger Front Bumper for your Polaris General. Designed to give the General a bold rock crawler look while maintaining the function of the factory winch. Be sure to check out the full line of DragonFire Accessories for your Polaris vehicle at your local authorized dealer or online at <http://www.DragonFireRacing.com>

! WARNING

- Read and understand these instructions before installing product
- This product does not provide roll over protection
- This product does not guarantee front end protection in the event of a collision
- This product is not intended as an anchor point for pulling
- Do not use product if there are any signs of damage

Disclaimer

Off road activities can be hazardous and could lead to injury, dismemberment, paralysis and death. No warranty of representation is made as to the products ability to protect the user from any injury or death. The user assumes that risk. The acceptance and /or use of this merchandise purchased from DragonFire by the customer hereby shall release DragonFire from any and all liability pertaining to the use of such merchandise.

Part & Hardware List

ITEM	QTY	SIZE	LENGTH	TYPE	STEP USED
P1	1	-	-	Bumper Sub-structure	5
P2	1	-	-	Bumper Cover	8
P3	1	-	-	Stinger Assembly	10
P4	2	3/8-16	1"	Hex Head Bolt, Grade 8	6*
P5	10	3/8-16	3/4"	Hex Head Bolt, Grade 8	6*, 7, 8, 9 & 10
P6	14	3/8	-	USS Flat Washer, Grade 8	6*, 7, 8, 9, & 10
P7	2	3/8-16	-	Nylon Lock Nut, Grade 8	6*

* If not using OE Bumper hardware

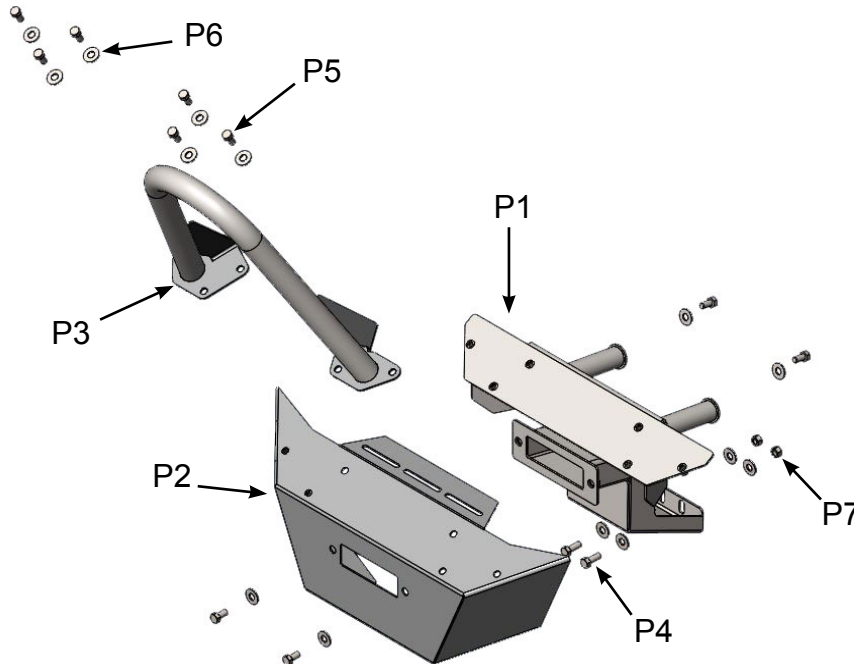

Tools Required

- | |
|-------------------------|
| Ratchet |
| 15mm Socket and Wrench |
| 9/16" Socket and Wrench |
| 3" Extension |

Step 1: Place vehicle on a flat and level surface. Place gear selector in "Park" and remove keys from the ignition.

Step 2: If vehicle does not have an OE bumper, skip to Step 4. If the vehicle comes equipped with an OE bumper and/or winch, remove pin on the winch hook and set aside for later use. Remove OE fair-lead and front bumper. **(Figure A)**

Step 3: Retain the OE Bumper lower mounting bolts and nut plate **(Figure B)** to be reused. (NOTE: Leave nut plate installed on vehicle. Image shows the part removed to represent actual part.)

Step 4: Remove hood and upper grill insert **(Figure C)** from vehicle and set aside to be reinstalled later.



Step 5: If vehicle is equipped with a winch, pull out 12"-18" of winch cable. Locate Bumper Sub-Structure (P1) and feed winch cable through the rectangular tube. **(Figure D)**

Step 6: Place the Sub-Structure on the vehicle and secure with the lower mounting bolts removed from the OE bumper. **(Figure E)**
(Note: If vehicle did not come with an OE Bumper, use supplied hardware P4, P6 and P7). Leave hardware loose for adjustment.

Step 7: Reach behind the lower grill and install one provided flat washer (P6) and one provided 3/4" hex bolt (P5) into each of the upper mounts to secure to the vehicle. Leave hardware loose for adjustment. **(Figure F)**

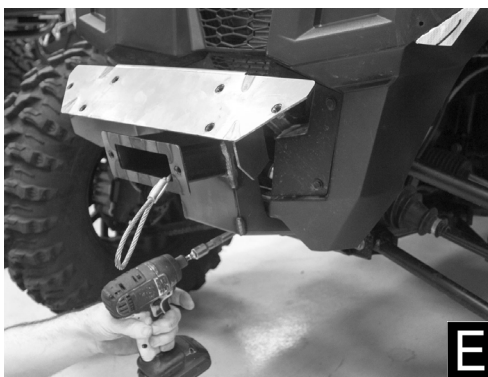
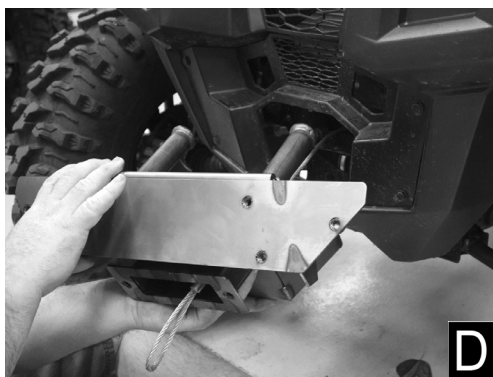

Step 8: Locate Bumper Cover (P2) and place on to Sub-Structure (P1) installed in previous step. **(Figure G)** Loosely install one supplied bolt (P5) into one of the top holes to hold the cover in place.

Step 9: Reinstall OE fair-lead onto bumper cover using supplied flat washers (P6) and supplied bolts (P5). **(Figure H)** Leave hardware loose.

Step 10: Remove bolt installed in Step 8 and install the Stinger Assembly (P3) on the bumper cover using provided flat washers (P6) and bolts (P5). **(Figure I)** Leave hardware loose for adjustment.

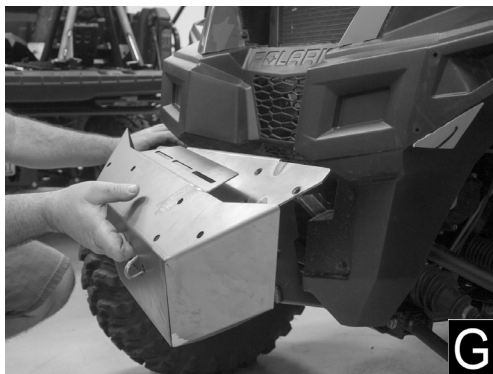

Step 11: Snug all 6 fasteners on the Stinger Assembly (P3) and the 2 fasteners on the fair-lead. Verify the base plates on the stinger align evenly to the front edge of the cover and torque fasteners to 35 ft-lbs. **(Figure J)**

Step 12: Inspect the alignment of the bumper on the vehicle and torque the 4 mounting bolts (installed in **steps 6 & 7**) to 35 ft-lbs.

Step 13: Reinstall hook on the winch cable **(Figure K)**.

Step 14: Reinstall upper grill and hood on to vehicle.

Step 15: This completes the installation. Time to ride and enjoy!

ProTip: Periodically check all hardware and re-tighten if needed.

For further assistance, please contact us at customerservice@dragonfireracing.com or 1-800-708-9803.

